

# **Dönder**

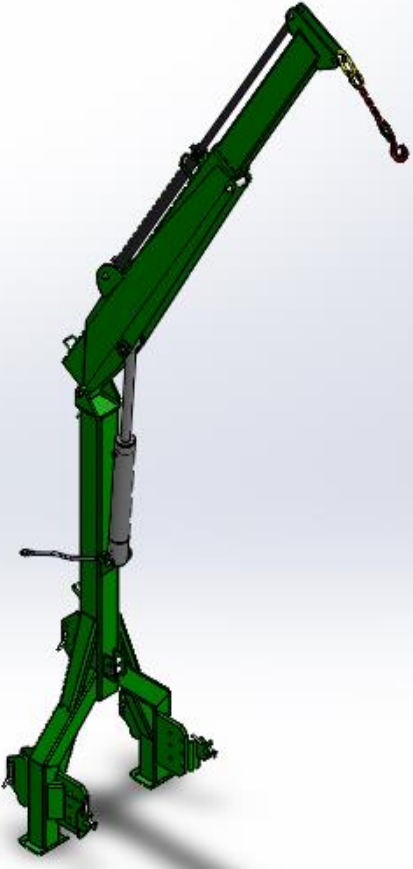

## **BIG BAG LIFTER LONG 5.50**

- Operating Manual**
- Lubricating Diagram**
- Spare Parts Catalogue**

DÖNDER TARIM MAK\_NALARI SAN. TIC. LTD. STI

Bodrum Yolu Üzeri Yenidoğan Beldesi

Söke- Aydın-TÜRKİYE

Tel: 0256 521 02 24 (pbx) 0256 521 01 09  
(Fax)

[www.dondertarim.com.tr](http://www.dondertarim.com.tr)  
[info@dondertarim.com.tr](mailto:info@dondertarim.com.tr)

# Table of Contents

GENERAL .....	3
DESCRIPTION .....	3
WARRANTY .....	3
GUIDELINES FOR PROPER USE .....	4
CONNECTING THE MACHINE TO THE TRACTOR .....	4
SAFETY AND MAINTENANCE .....	4
SAFETY SIGNS .....	5
USING THE MACHINE .....	7
LUBRICATING DIAGRAM .....	8
TECHNICAL SPECIFICATIONS .....	9
NOTES: .....	10
SPARE PARTS LIST.....	11

## GENERAL

BAG LIFTER, produced by our company in accordance with various types of fertilizer spreaders, which is also able to operate in combination with these machines, will provide you great convenience in emptying your large fertilizer bags.

## DESCRIPTION

BAG LIFTER that is manufactured in accordance with 2nd and 3rd category tractors is connected to the tractor by means of the three point linkage system.

BAG LIFTER, being designed by our company in order to enable the emptying of large fertilizer bags into the fertilizer spreader will provide you time and convenience in your business.

BAG LIFTER, having a lifting capacity of 1000 kg, will ensure a secure use.



We have used this symbol in all matters concerning your safety. If the machine is to be used by someone other than you, inform about the safety and use.

## WARRANTY

At the time when you have the machine delivered, first check whether there is any missing equipment or whether there is any damage caused by the delivery, and have this approved to the person who has delivered it to you. Complaints related to warranty are only taken into consideration if the terms of the warranty are fully complied. From the date of delivery, the machine has a warranty of 1 year against manufacturing and material defects.

## *DISCLAIMER OF WARRANTY*

- \_ Using the machine outside the specified technical values,*
- \_ Any modification on the machine without the approval of the manufacturing Company*
- \_ Using the machine for purposes other than production,*
- \_ Failing to use original spare parts determined by the manufacturing company*

## GUIDELINES FOR PROPER USE

BAG LIFTER is constitutively intended for agricultural purposes. Using it for different purposes is the responsibility of the user. The manufacturer is not responsible for damages caused by different uses. These guidelines for proper use intent to use the product in accordance with the operating, maintenance and service rules specified by the manufacturing company.

The manufacturing company shall not be held responsible for any damages and losses that may occur due to modifications performed on the machine without the consent of the manufacturing company.

## CONNECTING THE MACHINE TO THE TRACTOR

\_ Move the hydraulic arms into appropriate position before connecting the machine to the tractor.

\_ The machine has been manufactured in accordance with 2nd and 3rd category tractors. Ensure that the connection categories of the tractor and machine are the same in order to enable connection with the three-point linkage system.

\_ Do not forget the risk of being squeezed while connecting the machine with the three-point linkage system.

\_ Do not stay between the machine and tractor while making connection with the three-point linkage system.

## SAFETY AND MAINTENANCE

\_ Make sure that the machine is not running before performing any operations such as maintenance, cleaning, etc. If the tractor is running then stop it.

\_ Make sure that the tractor is in inoperable position during operations such as maintenance etc.

\_ Make oiling and greasing processes properly

\_ Never stay under the load when having lifted a load with the machine

If the machine is to be left in parking position for a long term, use the support leg and take the boom in.

To prevent damage to hydraulic hoses, connect to the hose strap and lock.



1

2



3



4



5



6



7



8



9



10



11



12



13



14



15



16

1. Pay attention to the shaft.
2. PTO rpm 540 r/min
3. Attention! Do not enter between the machine and tractor.
4. Consult the operating manual.
5. Attention! Do not approach by hand.
6. Machine loading/suspension point
7. Grease lubrication information.
8. Do not attach a trailer behind the tractor.
9. Shaft information
10. Wash your machine with clean water at the end of your work.
11. Risk of tearing hands and fingers due to moving elements
12. Risk of crushing hands and fingers due to moving accessible machine parts
13. Material scattered by the machine or material scattering out from the Machine
14. Risk of falling or injury when climbed onto the moving machine
15. Risk of arm or body injury due to unprotected machine elements
16. Danger of being crushed under machine parts



Never stay under load and let anybody else stay under load when load is lifted by the machine.

## USING THE MACHINE

### CONNECTING THE MACHINE TO THE TRACTOR AND FERTILIZER SPREADER

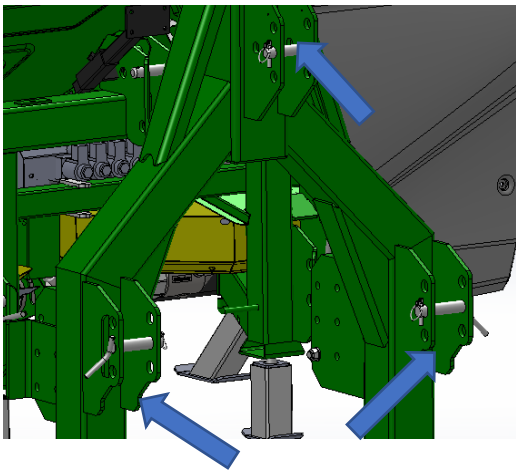

- . Move the hydraulic arm to appropriate position in order to connect the machine to the tractor and approach the BAG LIFTER.
- . Connect in accordance with the three-point linkage system and attach the pins.
- . Adjust the mid arm in appropriate length
- . Connect the hydraulic hoses to the tractor.

➔ Remove the pins of the connection jaw in order to connect the BAG LIFTER that you connected to the Tractor with the fertilizer spreader.

➔ Then, approach the tractor and fertilizer spreader and connect the perno pins of the fertilizer spreader to the perno jaws of the BAG LIFTER as shown in the illustration and insert the pins.

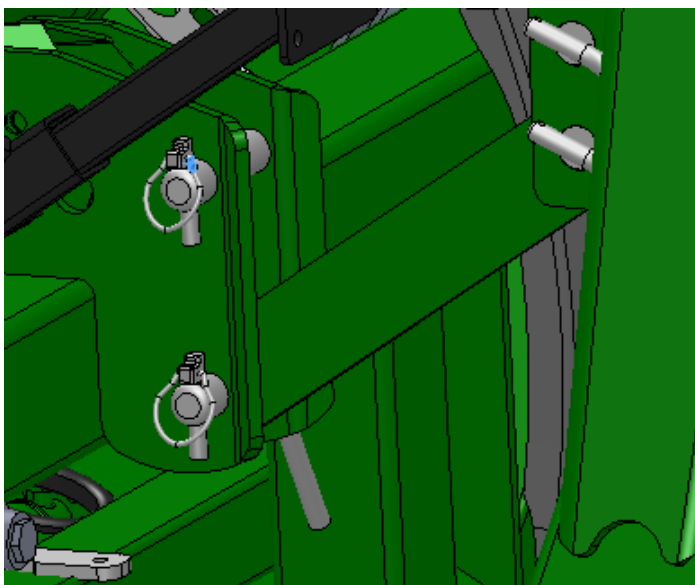
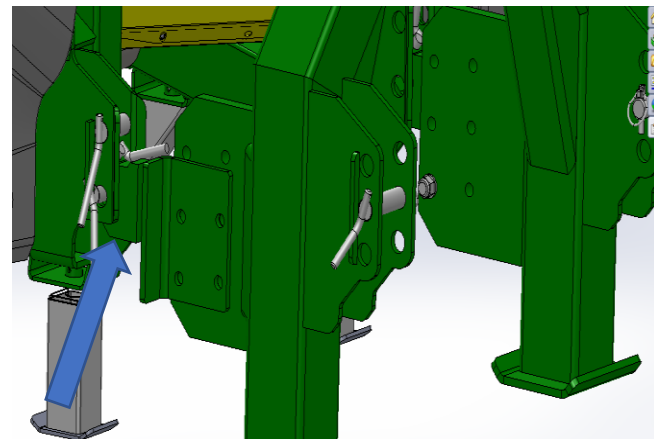

➔ After having connected the perno jaws connect the adaptor part to the BAG LIFTER and fertilizer spreader as shown in the illustration and insert the pins.

➔ Adjust the mid arm accordingly.

➔ The machine is ready for use after having set the appropriate height..

# LUBRICATING DIAGRAM

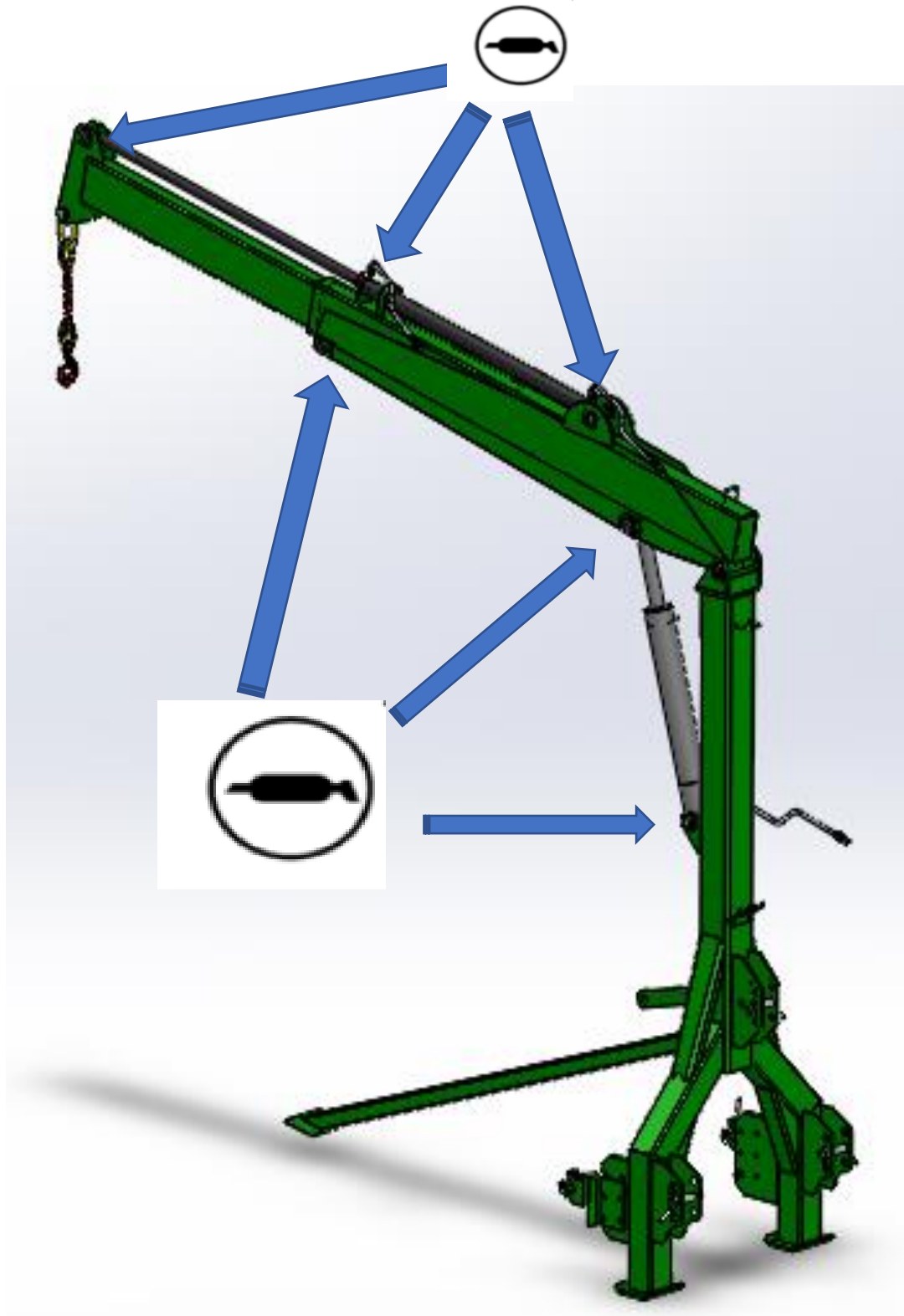



# TECHNICAL SPECIFICATIONS

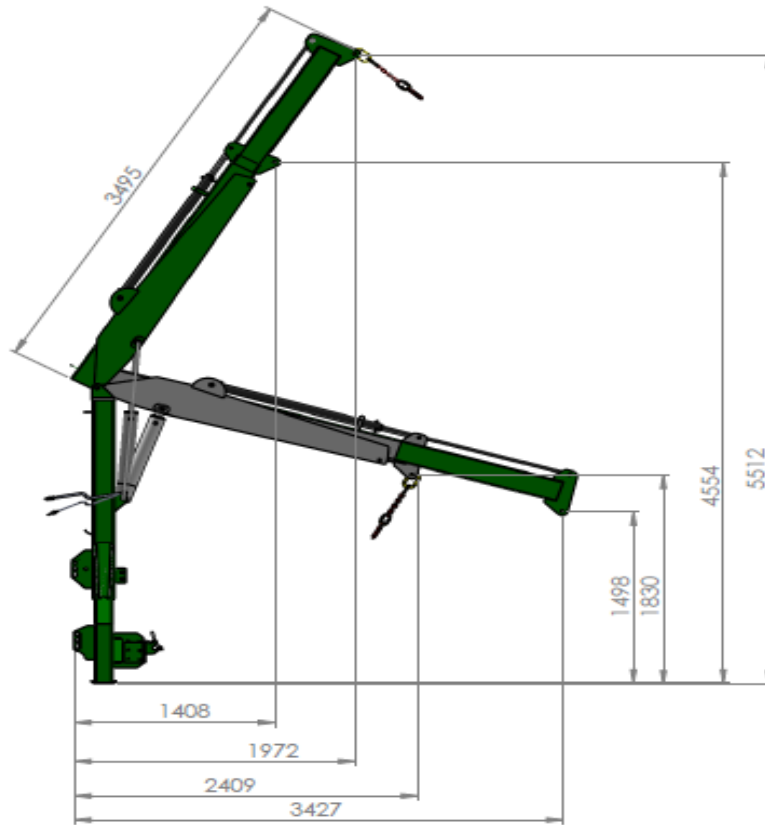

MODEL	Lifting capacity when boom is in (kg)	Lifting capacity when boom is out (kg)	Machine Weight (kg))
BL1000	1000	600	450

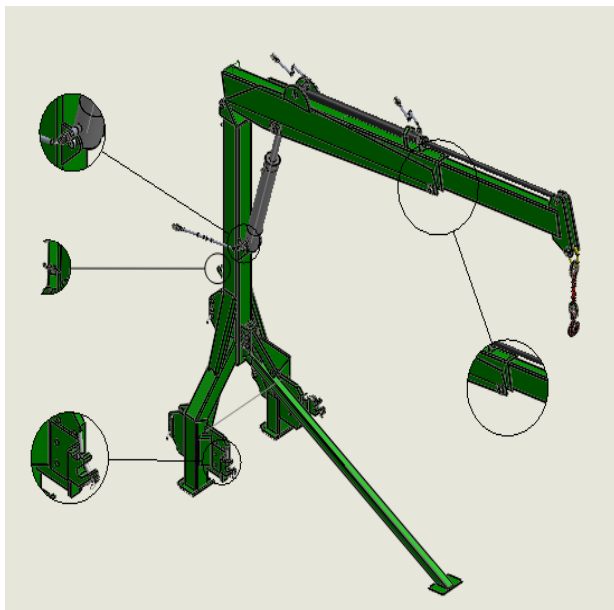

\_ Safety Valve: In the event of a failure at the hydraulic cylinder, or when hoses are damaged when exposed to excessive load, it prevents the sudden closure of the cylinder

\_ Hose Hanger: Prevents damage to hydraulic hoses in parking position.

\_ Perno Connection Jaws: Provides convenience in the connection of the fertilizer spreader to the

\_ Boom Reel: Provides smooth boom extension/collection



SPARE PARTS LIST



**BAG LIFTER  
SPARE PARTS LIST**

# BBL 5.50 YEDEK PARÇA LİSTESİ

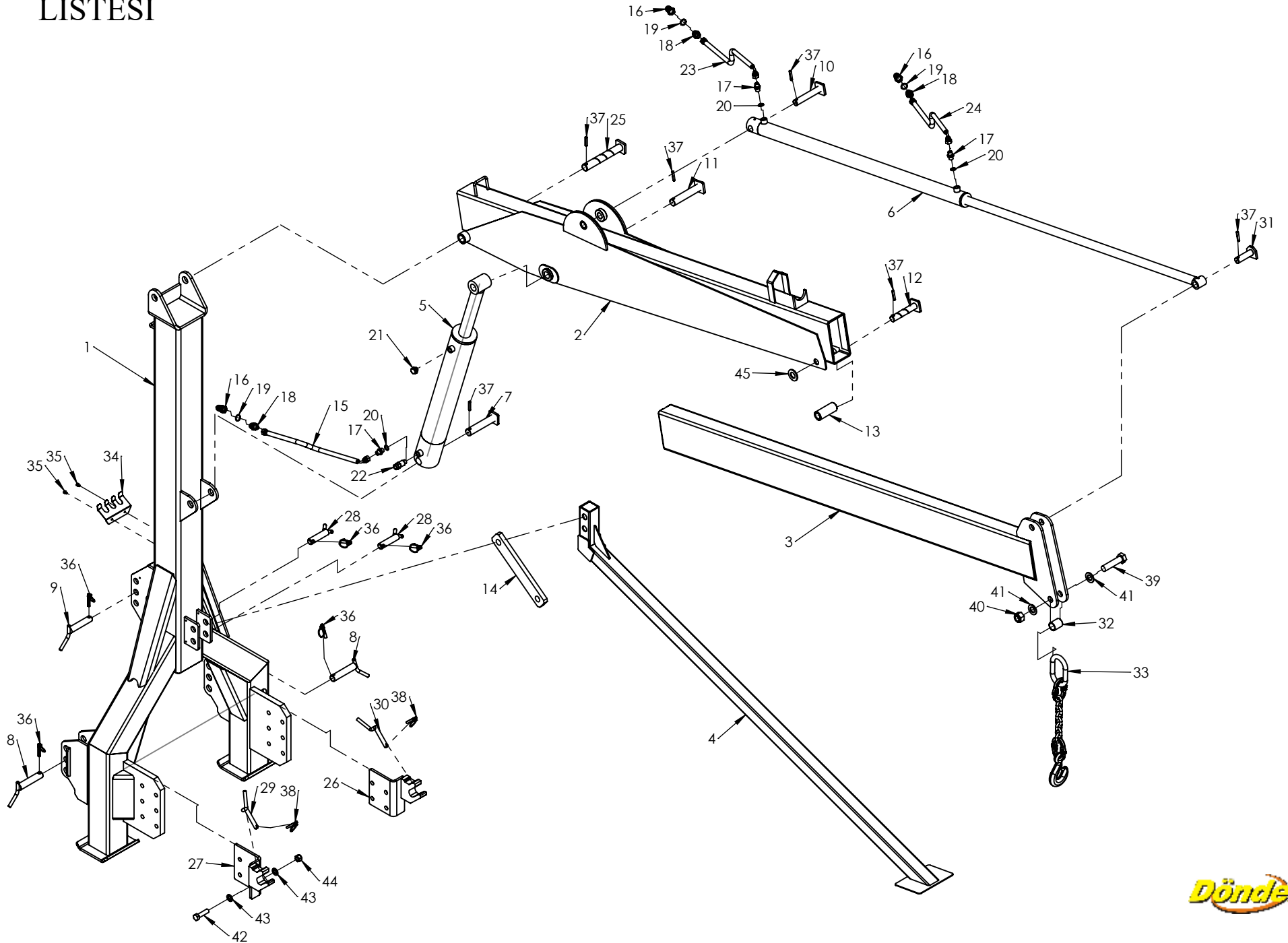

NR	Part number	Part Name(en)	Quantity
1	1701001	BBL LONG Lower Chassis	1
2	1701002	BBL LONG Upper Chassis	1
3	1701003	BBL LONG Boom	1
4	1701004	BBL LONG Leg	1
5	1702001	BBL 5,5 Lower Piston	1
6	1702002	BBL Long Upper Piston	1
7	1703002	Lower Piston Lower Pin	1
8	1703003	Hydraulic Arm Pin	2
9	1703004	Middle Arm Pin	1
10	1703005	Upper Piston Black Pin	1
11	1703006	Lower Piston Upper Pin	1
12	1703007	Pulley Pin	1
13	1703008	Pulley	1
14	1703009	BBL-Long Machinery adapter	1
15	1704001	BBL 5.50 lower piston hose	1
16	1704004	1/2 Jack	3
17	1704005	3/8 Nipel	3
18	1704006	1/2 Nipel 3/8	3
19	1704007	1/2 Copper Washer	3
20	1704008	3/8 Copper Washer	3
21	1704009	Ventilation plug	1
22	1704010	Blasting Valve	1
23	1704011	BBL 5.50 Upper Piston Short Pipe	1
24	1704012	BBL 5.50 Upper Piston Long Pipe	1
25	1601018	Connection Pin	1
26	1601006	Perno Jaw (left)	1
27	1601005	Perno Jaw (right)	1
28	1601020	Middle Arm, Leg Pin	2
29	1601022	Perno Jaw Pin (right)	1
30	1601029	Perno Jaw Pin (left)	1
31	1601027	Upper Piston Front Pin	1
32	1601028	Hook Connection Pipe	1
33	1601017	Loading Hook	1
34	1601016	Hose Hanger	1
35	005.100.035	M6X10 Bolt	2
36	005.800.007	Ø10 Spring Pin	5
37	005.700.191	8.5 Split pin	6
38	005.800.007	Ø10 Spring Pin	2
39	005.100.398	Metric 24 Bolt	1
40	005.151.012	M24 Fiber Nut	1
41	005.200.014	M24 Washer	2
42	005.100.254	M16X60 Bolt	1
43	005.200.010	M16 Inox Washer	2
44	005.151.008	M16 Fiber Nut	1
45	005.200.015	M26 Washer	1